

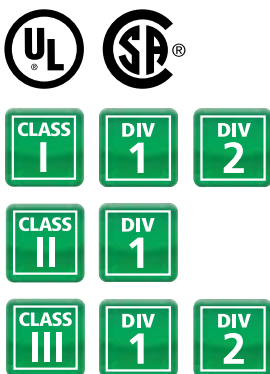

GA series Aluminium external hubs



Approvals / Characteristics



Features

- Junction for branch conduits in hazardous locations
- Accessible wiring chamber provides a convenient location to maintain or change a system, pull conductors and make splices
- Unique mounting pads and external hub design ideal for installations of OEM devices or instruments
- Copper-free aluminium provides increased corrosion resistance
- Precision cast and machined surfaces permit safer wire pulling

Certification and standards

UL Listed and CSA Certified for hazardous locations:
 Class I Div 1 & 2 CD
 Class II Div 1 EFG
 Class III Div 1 & 2
 NEMA 4 (when ordered with O-ring installed)

Aluminium external hubs - GA series

Dimensions

Technical specifications

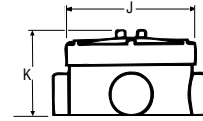
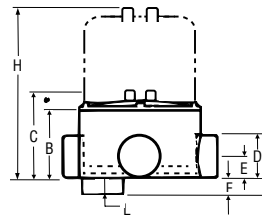
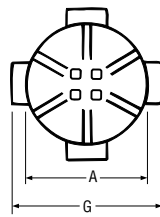

Dimensions of all styles when GAJ cover is used

GAC / GAE / GAL / GALB / GAT / GAX

GAC / GAE / GAL / GALB / GAT / GAX

Dimensions (inch)

Cover Opening	Hub Size	A	B	C	D	E	F	G	H	J	K	L	CI
3 11/16	1/2"	4	2 1/4	2 15/16	1 3/8	11/16	11/16	5 3/16	5 9/16	4 3/16	3 5/16	9/16	18.8
3 11/16	3/4"	4	2 1/4	2 15/16	1 3/8	11/16	11/16	5 3/16	5 9/16	4 3/16	3 5/16	9/16	18.8
3 11/16	1"	4	2 1/4	2 15/16	1 5/8	13/16	27/32	5 1/2	5 9/16	4 3/16	3 5/16	9/16	18.8
3 29/32	1 1/4"	4 5/16	3	3 11/16	2 1/16	1 1/32	7/8	5 11/16	—	4 9/16	3 5/16	5/8	28.0
5 3/16	1 1/2"	5 3/4	4 1/4	5 1/16	2 7/8	1 7/16	7/8	6 5/8	—	6 7/16	5 15/32	13/16	69.3
5 3/16	2"	5 3/4	4 1/4	5 1/16	2 7/8	1 7/16	7/8	6 5/8	—	6 7/16	5 15/32	13/16	69.3

GAC - through feed with surface cover

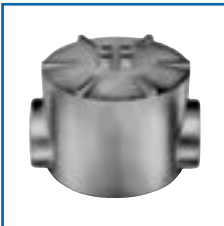

Type	Hub Size	Unit Quantity	Standard Package	Weight per 100 (lbs)
GAC-1*	1/2"	1	5	115
GAC-2*	3/4"	1	5	115
GAC-3*	1"	1	5	115

*Made-to-order items. Contact sales for lead time and minimum quantities

GAE - dead end with surface cover

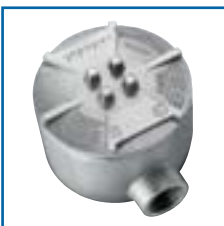

Type	Hub Size	Unit Quantity	Standard Package	Weight per 100 (lbs)
GAE-2*	3/4"	1	5	110

*Made-to-order items. Contact sales for lead time and minimum quantities

GAL - L style with surface cover



Type	Hub Size	Unit Quantity	Standard Package	Weight per 100 (lbs)
GAL-1	1/2"	1	5	115
GAL-2*	3/4"	1	5	115
GAL-3*	1"	1	5	115
GAL-4*	1 1/4"	1	5	175
GAL-5*	1 1/2"	1	4	247
GAL-6*	2"	1	4	253

*Made-to-order items. Contact sales for lead time and minimum quantities

Aluminium external hubs

Technical specifications

GALB - LB style with surface cover



Type	Hub Size	Unit Quantity	Standard Package	Weight per 100 (lbs)
GALB-1*	1/2"	1	5	115
GALB-2	3/4"	1	5	115
GALB-3*	1"	1	5	115
GALB-4*	1 1/4"	1	2	175
GALB-6*	2"	1	4	253

*Made-to-order items. Contact sales for lead time and minimum quantities

GAT - T style with surface cover



Type	Hub Size	Unit Quantity	Standard Package	Weight per 100 (lbs)
GAT-1*	1/2"	1	5	120
GAT-2	3/4"	1	5	120
GAT-3*	1"	1	5	120
GAT-4	1 1/4"	1	5	180
GAT-6*	2"	1	1	406

*Made-to-order items. Contact sales for lead time and minimum quantities

GAX - X style with surface cover



Type	Hub Size	Unit Quantity	Standard Package	Weight per 100 (lbs)
GAX-1**	1/2"	1	5	125
GAX-2*	3/4"	1	5	125
GAX-3**	1"	1	5	125
GAX-5**	1 1/2"	1	1	257

*Made-to-order items. Contact sales for lead time and minimum quantities

**O-ring available for NEMA 4 rating

GAS - surface-style cover



Type	Cover Opening	Fit Boxes	Standard Package	Weight per 100 (lbs)
GAS-123*	3 11/16"	1/2", 3/4", 1"	1	36
GAS-4*	3 29/32"	1 1/4"	1	52
GAS-56*	5 3/16"	1 1/2", 2"	1	69

*Made-to-order items. Contact sales for lead time and minimum quantities

GAD - dome-style cover (Class I, Group D only)



Type	Cover Opening	Fit Boxes	Inside Height	Cubic Inch Capacity	Standard Package	Weight per 100 (lbs)
GAD-123*	3 11/16"	1/2", 3/4", 1"	2 5/8"	23	1	71

*Made-to-order items. Contact sales for lead time and minimum quantities

Aluminium external hubs - GA series



Dimensions

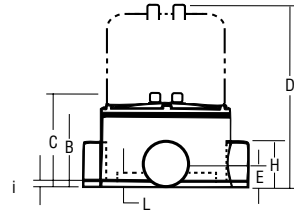
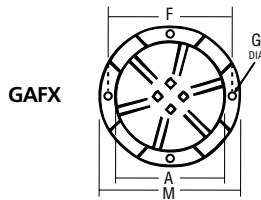

GAJU

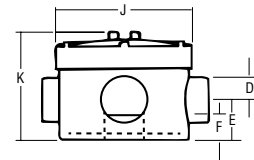
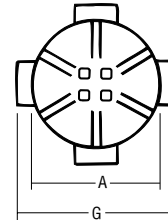

Technical specifications

GAFX - X style with flange and surface cover



Type	Hub Size	Unit Quantity	Standard Package	Weight per 100 (lbs)
GAFX-1**	1/2"	1	4	135
GAFX-2**	3/4"	1	4	135

**O-ring available for NEMA 4 rating

GAFX		Dimensions (inch)										
Cover Opening	Hub Size	A	B	C	D	E	F	G	H	L	M	CI
3 11/16	1/2"	4	2 1/4	2 15/16	5 9/16	11 1/16	4 1/2	1 1/4	1 3/8	9/16	5 3/16	20.0
3 11/16	3/4"	4	2 1/4	2 15/16	5 9/16	11 1/16	4 1/2	1 1/4	1 3/8	9/16	5 3/16	20.0
3 11/16	1"	4	2 1/4	2 15/16	5 9/16	13 1/16	4 3/4	5/16	1 5/8	9/16	5 1/2	19.0

*Note: All GAF units supplied as X configuration with proper number of explosion-proof close-up plugs to make C, T or L

GAJU - style with canopy cover with cover and plugs

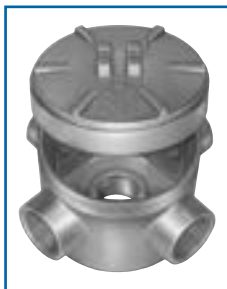

Type	Hub Size	Unit Quantity	Standard Package	Weight per 100 (lbs)
GAJU-2	3/4"	1	5	130
GAJU-3	1"	1	5	130
GAJU-6*	2"	1	1	273

*Made-to-order items. Contact sales for lead time and minimum quantities

GAJU		Dimensions (inch)									
Cover Opening	Hub Size	A	B	E	F	G	J	K	CI		
3 11/16	1/2"	4	13/16	1 1/2	31/32	5 3/16	4 3/16	4	23.8		
3 11/16	3/4"	4	13/16	1 1/2	31/32	5 3/16	4 3/16	4	23.8		
3 11/16	1"	4	13/16	1 1/2	31/32	5 3/16	4 3/16	4	23.8		
3 29/32	1 1/4"	4 5/16	2 1/16	1 1/32	7/8	5 11/16	4 3/4	3 15/16	33.3		
5 3/16	1 1/2"	5 3/4	1 7/16	2 1/16	1 1/2	6 5/8	6 7/16	6 3/16	82.8		
5 3/16	2"	5 3/4	1 7/16	2 1/16	1 1/2	6 5/8	6 7/16	6 3/16	82.8		

*All GA & GAF series boxes are supplied with GAS or GAJ style covers. To order these boxes with GAD dome cover, contact sales

GAJ - canopy-style cover



Type	Cover Opening	Fit Boxes	Unit Quantity	Standard Package	Weight per 100 (lbs)
GAJ-123*	3 11/16"	1/2", 3/4", 1"	1	10	44
GAJ-4*	3 29/32"	1 1/4"	1	5	61
GAJ-56*	5 3/16"	1 1/2", 2"	1	5	78

*Made-to-order items. Contact sales for lead time and minimum quantities