

# FD17 Series



The Eaton FD17 high pressure coupling can be connected by hand while under pressure up to 4,500 psi/310 bar. This quick disconnect coupling is most commonly used in SCBA transfilling and buddy breathing applications and is commonly found on SCBA equipment certified to various NIOSH, NFPA and CBRN standards.

## Product Features

- Connect and disconnect under pressure up to 4,500 psi/310 bar
- Certified on SCBA equipment that meets NIOSH, NFPA 1981 and CRN requirements
- Complies with NFPA 1981
- Standard body material: Stainless steel, aluminum

## Physical Characteristics

Series	Max. Operating Pressure		Min. Burst Pressure		Rated Flow*		Rated Temperature
	(bar)	(psi)	(bar)	(psi)	(lpm)	scfm	
FD17	310	4,500	930	13,500	125	4.4	-25°F (-32°C)/+160°F (+71°C)

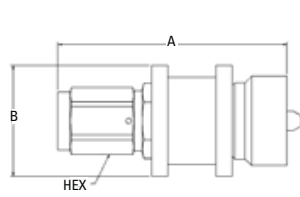

Figure 1

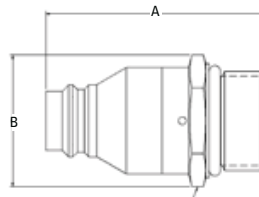

Figure 2

Part Number	Coupling Type	Body Size	Port Size	Thread	Type	Fig.	Dimensions			A	B	Hex
							A	B	Hex			
							(in)	(in)	(in)	(mm)	(mm)	(mm)
FD17-1003-04-04	Socket/Female	1/4	-4	7/16-20	ORB	1	2.85	1.38	0.75	72.4	35.1	19.1
FD17-1002-10-04	Plug/Male	1/4	-10	7/8-14	ORB	2	1.93	1.43	1	49.0	36.3	25.4



### Male Dust Cap

#### Part Number

FD17-1064-04

### Female Dust Cap

#### Part Number

FD17-1062-04

Eaton快速接头代理商：信德迈科技(北京)有限公司 Tel: 010-8428 2935 Email: sales@cnmec.biz