

# Thermoplastic Couplings

PPA Series

## Quick Connections with a “CLICK”

Parker Hannifin's new PPA push-button couplings combine the advantages of thermoplastic material with the traditional flow functions found in metal couplings. Users can be assured of making easy and secure connections with the simple push-button latch operation and audible “CLICK.”

The PPA Series couplings offer a streamline design providing users with longer seal life, resistance to accidental disconnections, and greater chemical compatibility. These features make the PPA Series ideal for medical, laboratory, consumer, instrumentation, and industrial applications.



## Contact Information:

Parker Hannifin Corporation  
**Quick Coupling Division**  
8145 Lewis Road  
Minneapolis, MN 55427

phone 763 544 7781  
fax 763 544 3418  
qcd\_sales@parker.com

[www.parker.com/clicktoconnect](http://www.parker.com/clicktoconnect)



## PPA Push-Button Coupling Features:

- Easy-to-use Push-to-Connect design, with audible “CLICK” upon connection
- Smooth operating, all plastic push-button latch, highly resistant to accidental disconnect
- Available in a variety of common configurations, port and valving options
- Streamline, compact and lightweight ergonomic design
- Resistant to many chemicals, and suitable for liquid and gas applications

ENGINEERING YOUR SUCCESS.

# PPA Series Specifications



PPA Series Specs						
Series	Flow Capacity	Rated Pressure	Temperature	Material: Body & Latch	Material: Springs	O-ring
PPA	1/4"	Vacuum to 120 psig	-40° F to +180° F -40° C to +82° C	Acetal Copolymer	Stainless Steel	Nitrile

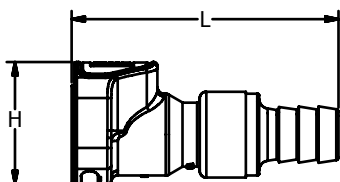

VALVED COUPLER

Couplers					
Body Size	Coupler Part Number	Port*	Valved	Length	Height
1/4"	PPA-251-4HB	1/4" Hose Barb	Yes	2.03"	0.93"
1/4"	PPA-251-6HB	3/8" Hose Barb	Yes	2.04"	0.93"

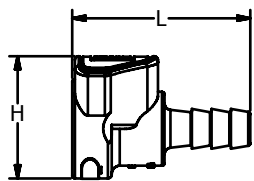

UNVALVED COUPLER

Couplers					
Body Size	Coupler Part Number	Port*	Valved	Length	Height
1/4"	PPA-253-4HBSB	1/4" Hose Barb	No	1.36"	0.93"
1/4"	PPA-253-6HBSB	3/8" Hose Barb	No	1.36"	0.93"

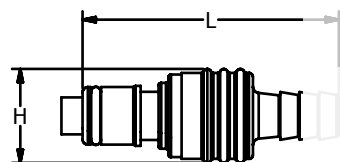

VALVED NIPPLE

Nipples					
Body Size	Nipple Part Number	Port*	Valved	Length	Height
1/4"	PPA-252-4HB	1/4" Hose Barb	Yes	1.89"	0.71"
1/4"	PPA-252-6HB	3/8" Hose Barb	Yes	1.75"	0.71"

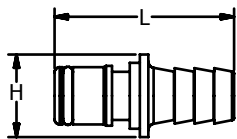

UNVALVED NIPPLE

Nipples					
Body Size	Nipple Part Number	Port*	Valved	Length	Height
1/4"	PPA-254-4HB	1/4" Hose Barb	No	1.35"	0.63"
1/4"	PPA-254-6HB	3/8" Hose Barb	No	1.36"	0.61"

\*Consult factory for other port options



ENGINEERING YOUR SUCCESS.