



Technical Description

This coupling system can be used as straight-through and double shut-off. Also available in stainless steel.

Connected length in total: 108 mm

Available Valves

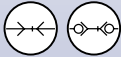

Advantages

Straight-through – minimum pressure drop. Double safety through a double O-ring seal. A safety closing ring prevents unintentional uncoupling. Corrosion resistant. Compact dimensions. Pressure eliminator is available for coupling and plug. With pressure eliminator, can be coupled up to operating pressure.

Working Pressure

See chart.

Working Temperature*

-30°C up to +100°C (NBR)
-25°C up to +200°C (FKM)
depending on the medium.

*At a temperature below -40°C and above +200°C special seals are available on request.



Material

Coupling

Coupling Body
Sleeve

Locking Ring

Valve

Springs

Locking Balls

Seals

Valve Holder

Standard

Brass, Nickel Plated, Chromated
Steel Hardened, Zinc Plated,
Yellow passivated, sealed
Brass, Zinc-iron coated, Black
passivated, sealed

Brass

AISI 301

AISI 420 C

NBR/FKM

Brass

Stainless Steel

AISI 316

AISI 316

AISI 316

AISI 316

AISI 301

AISI 420 C

FKM

AISI 316

Plug

Plug Body

Valve

Springs

Seals

Valve Holder

Brass Version

Brass

AISI 316

Brass

AISI 301

NBR/FKM

Brass

AISI 316

AISI 301

FKM

AISI 316

Pressures (Coupling/Plug)

Bursting Pressure coupled

> 930 bar/930 bar

> 200 bar

> 1000 bar

Working Pressure uncoupled

200 bar/250 bar

50 bar

200 bar

Flow Capacity
Viscosity for 32cSt at 40°C
as per ISO 7241/2-2000

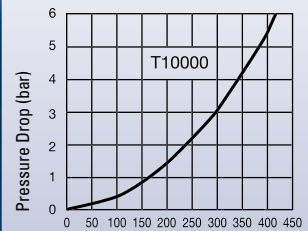

Flow Rate l/min

Couplings

TEMA Series T10000

	Connec- tion A	Hex SW	L mm	D mm	Valve	Working press. in bar	Version	Seal	Part Number	DS
<p>Female Thread</p>	G 1	45	88	62	with	250	Standard	NBR	T10010	■
	G 1	45	88	62	with	250	Standard	FKM	T10010 V	■
	G 1	45	88	62	with	250	Stainless Steel	FKM	T10010 RV ²⁾	■
	G 1	45	88	62	without	250	Standard	NBR	T10010 UV	■
	G 1	45	88	62	without	250	Standard	FKM	T10010 VUV	■
	G 1	45	88	62	without	250	Stainless Steel	FKM	T10010 RVUV ²⁾	■

DS = Delivery Status:

■ in stock

■ on short call

■ medium term delivery

Couplings with Pressure Eliminator

TEMA Series T10000

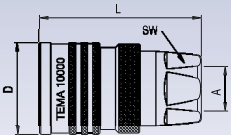
	Connection A	Hex SW	L mm	D mm	Valve	Working press. in bar	Version	Seal	Part Number	DS
 <p>Female Thread</p>	G 1	45	88	62	with	250	Standard	NBR	T10011	<input type="checkbox"/>
	G 1	45	88	62	with	250	Standard	FKM	T10011 V	<input type="checkbox"/>
	G 1	45	88	62	with	250	Stainless Steel	FKM	T10011 RV ²⁾	<input type="checkbox"/>
	G 1	45	88	62	with	250	Stainless Steel	FKM	T10011 RFV ^{1) 2)}	<input type="checkbox"/>

Plugs

TEMA Series T10000

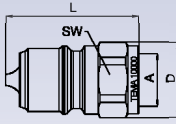
	Connection A	Hex SW	L mm	D mm	Valve	Working press. in bar	Version	Seal	Part Number	DS
 <p>Female Thread</p>	G 1	46	60	49	with	280	Standard	NBR	T10020	<input type="checkbox"/>
	G 1	46	60	49	with	280	Standard	FKM	T10020 V	<input type="checkbox"/>
	G 1	46	60	49	with	250	Stainless Steel	FKM	T10020 RV ²⁾	<input type="checkbox"/>
	G 1	46	53	49	without	280	Standard		T10020 UV	<input type="checkbox"/>
	G 1	46	53	49	without	250	Stainless Steel		T10020 RUV ²⁾	<input type="checkbox"/>

Plugs with Pressure Eliminator

TEMA Series T10000

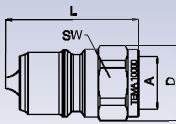
	Connection A	Hex SW	L mm	D mm	Valve	Working press. in bar	Version	Seal	Part Number	DS
 <p>Female Thread</p>	G 1	46	61	49	with	280	Standard	NBR	T10021	<input type="checkbox"/>
	G 1	46	61	49	with	280	Standard	FKM	T10021 V	<input type="checkbox"/>
	G 1	46	61	49	with	250	Stainless Steel	FKM	T10021 RV ²⁾	<input type="checkbox"/>
	G 1	46	61	49	with	250	Stainless Steel	FKM	T10021 RFV ^{1) 2)}	<input type="checkbox"/>

Lubrication Nipple

TEMA Series T10000

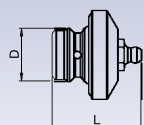
	Description	L mm	D mm	Part Number	DS
	Coupling	46	41	TGR10	<input type="checkbox"/>

¹⁾ Valve made of brass

²⁾ For pulsating pressure, the pressure must not exceed 50 % of the given value

Seal-Kit for Coupling

TEMA Series T10000

Description	Material	Part Number	DS
Coupling	NBR	T10000-PSN	■□
Coupling	FKM	T10000-PSV	■□
Further sealing materials on request.			

Dust Protection

TEMA Series T10000

Description	L mm	D mm	Material	Color	Part Number	DS
Coupling	230	90	PVC	Blue	T10016	■
Plug	230	76	PVC	Blue	T10026	■
Further colors on request.						

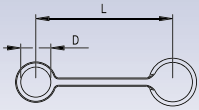

DS = Delivery Status:

■ in stock

■□ on short call

□ medium term delivery