



Nominal Diameter

5 = 20 mm²

RECTUS Series

17KA



actual size



Technical Description

English profile industrial coupling with UltraFlo technology, giving high flow performance. Specially suited to compressed air applications. Brass/steel design developed for industry. Compact dimensions and single handed operation make it suitable for numerous applications.

Advantages

Single handed operation. Small dimensions, light weight. High flow valve.

Interchangeability
SCHRADER NW 5

Working Pressure

PB = 35 bar, maximum static working pressure with safety factor 4 to 1.

Working Temperature*

-20°C up to +100°C (NBR)
-40°C up to +120/150°C (EPDM)
-15°C up to +200°C (FKM)
depending on the medium.

*At a temperature below -20°C and above +100°C special seals are available on request.

Chart

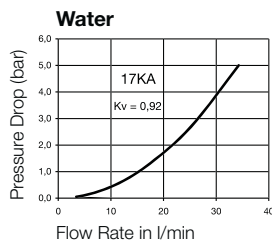
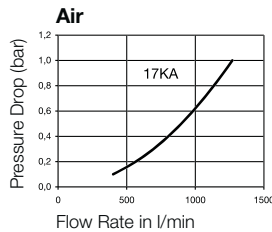

Material

- Coupling
 - Back Body
 - Valve Body
 - Sleeve
 - Valve
 - Inner Sleeve
 - Spring Plate
 - Spring and Locking Ring
 - Locking Balls
 - Seals

Standard

- Brass, Nickel Plated
- Steel Hardened and Nickel Plated
- Steel Hardened and Nickel Plated
- Brass
- Brass
- Brass
- Brass
- AISI 303
- AISI 420
- NBR

Plug

- Plug
 - Steel Hardened, Nickel Plated

Couplings

RECTUS Series 17KA

	Connection A	Hex SW	L mm	D mm	L1 mm	L2 mm	Hex1 SW1	B mm	G mm	Version	Part Number
<p>Male Thread</p>	R 1/4	19	63	23	12					Standard	17KA AK13 SPN
	R 3/8	19	62	23	12					Standard	17KA AK17 SPN
	R 1/2	22	63	23	17					Standard	17KA AK21 SPN
<p>Female Thread</p>	G 1/4	19	58	23	9					Standard	17KA IW13 SPN
	G 3/8	19	57	23	9					Standard	17KA IW17 SPN
	G 1/2	24	60	23	12					Standard	17KA IW21 SPN

Couplings

RECTUS Series 17KA

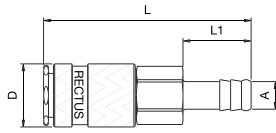

Hose Barb

Connection A	Hex SW	L mm	D mm	L1 mm	L2 mm	Hex1 SW1	B mm	G mm	Version	Part Number
6 mm	19	76	23	25					Standard	17KA TF06 SPN
8 mm	19	76	23	25					Standard	17KA TF08 SPN
10 mm	19	76	23	25					Standard	17KA TF10 SPN
13 mm	19	76	23	25					Standard	17KA TF13 SPN

Plugs

RECTUS Series 17KA

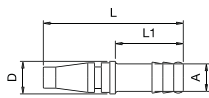

Hose Barb

Connection A	Hex SW	L mm	D mm	L1 mm	L2 mm	Hex1 SW1	B mm	G mm	Version	Part Number
6 mm		58	12	25					Standard	17SF TF06 SXN
8 mm		52	12	25					Standard	17SF TF08 SXN
10 mm		52	12	25					Standard	17SF TF10 SXN

Plugs

RECTUS Series 17KA

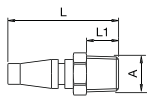

Male Thread

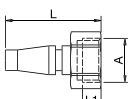

Female Thread

Connection A	Hex SW	L mm	D mm	L1 mm	L2 mm	Hex1 SW1	B mm	G mm	Version	Part Number
R 1/8	11	37		9					Standard	17SF AK10 SXN
R 1/4	14	42		12					Standard	17SF AK13 SXN
G 1/8	14	33		7					Standard	17SF IW10 SXN
G 1/4	17	36		9					Standard	17SF IW13 SXN

⚠ Please consider our security advices on the pages 12/13 ⚠