



Nominal Diameter

2,5 = 5 mm²

RECTUS Series

50KA

actual size

**Technical Description**

Mini industrial coupling, can be used with various media. Extremely easy to operate.

Advantages

Single handed operation.
Small installation dimensions.

Working Pressure

PB = 35 bar, maximum static working pressure with safety factor of 4 to 1.

Interchangeability

WALTHER LPO02

Working Temperature*

-20°C up to +100°C (NBR)
-40°C up to +120/150°C (EPDM)
-15°C up to +200°C (FKM)
depending on the medium.

*At a temperature below -20°C and above +100°C special seals are available on request.

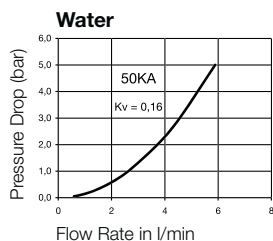
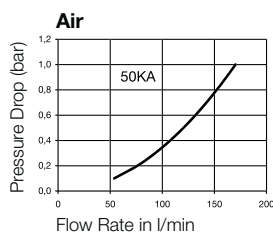
Chart**Material****Coupling**

Back Body
Valve Body
Sleeve
Valve
Spring and Locking Ring
Locking Balls
Seals

Standard

Brass
Brass
Brass
Brass
AISI 301
AISI 420
NBR

Nickel Plated

Brass, Nickel Plated
Brass, Nickel Plated
Brass, Nickel Plated
Brass
AISI 301
AISI 420
NBR

Plug

Plug

Brass

Brass, Nickel Plated

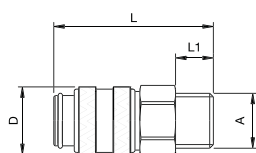
Couplings**RECTUS Series 50KA**

Male Thread

Connection A	Hex SW	L mm	D mm	L1 mm	L2 mm	Hex1 SW1	B mm	G mm	Version	Part Number
G 1/8	14	36	16	7					Standard	50KA AW10 MPXS
									Nickel Plated	50KA AW10 MPNS
G 1/4	17	38	16	9					Standard	50KA AW13 MPXS
									Nickel Plated	50KA AW13 MPNS

Couplings

RECTUS Series 50KA

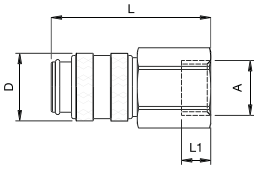
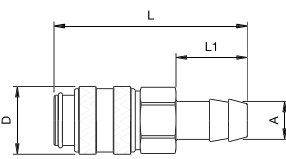
	Connection A	Hex SW	L mm	D mm	L1 mm	L2 mm	Hex1 SW1	B mm	G mm	Version	Part Number	
 <p>Female Thread</p>	G 1/8	14	36	16	9					Standard	50KA IW10 MPXS	
										Nickel Plated	50KA IW10 MPNS	
	G 1/4	17	38	16	9						Standard	50KA IW13 MPXS
											Nickel Plated	50KA IW13 MPNS
	 <p>Hose Barb</p>	4 mm	14	46	16	17					Standard	50KA TF04 MPXS
											Nickel Plated	50KA TF04 MPNS
6 mm		14	46	16	17						Standard	50KA TF06 MPXS
											Nickel Plated	50KA TF06 MPNS
9 mm		14	46	16	17						Standard	50KA TF09 MPXS
											Nickel Plated	50KA TF09 MPNS
10 mm	14	46	16	17						Standard	50KA TF10 MPXS	
										Nickel Plated	50KA TF10 MPNS	

Plugs

RECTUS Series 50KA

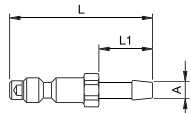
	Connection A	Hex SW	L mm	D mm	L1 mm	L2 mm	Hex1 SW1	B mm	G mm	Version	Part Number	
 <p>Hose Barb</p>	4 mm	7	35		13					Standard	50SF TF04 MXX	
										Nickel Plated	50SF TF04 MXN	
	6 mm	7	35		13						Standard	50SF TF06 MXX
											Nickel Plated	50SF TF06 MXN

Plugs

RECTUS Series 50KA

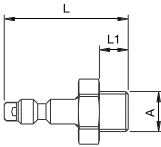
	Connection A	Hex SW	L mm	D mm	L1 mm	L2 mm	Hex1 SW1	B mm	G mm	Version	Part Number	
 <p>Male Thread</p>	G 1/8	14	30		7					Standard	50SF AW10 MXX	
										Nickel Plated	50SF AW10 MXN	
	G 1/8	14	30		7						Standard	50SF IW10 MXX
											Nickel Plated	50SF IW10 MXN

⚠ Please consider our security advices on the pages 12/13 ⚠