



Nominal Diameter

5 = 20 mm²

RECTUS Series

90KA

actual size



Technical Description

Small, splash-protected industrial coupling, specially developed for liquid media as the plug profile acts as a seal before the coupling valve is opened. Series 90 is a variant of series 21. Pin locking. Enlarged external sleeve diameter of 20 mm.

Advantages

Single handed operation. No loss through leakage during coupling.

Working Pressure

PB = 35 bar, maximum static working pressure with safety factor of 4 to 1.

Interchangeability

RECTUS 21
CAMOZZI
EWO
KANI

Working Temperature*

-20°C up to +100°C (NBR)
-40°C up to +120/150°C (EPDM)
-15°C up to +200°C (FKM)
0°C up to +316° (FFKM)
depending on the medium

*At a temperature below -20°C and above +100°C special seals are available on request.

Chart

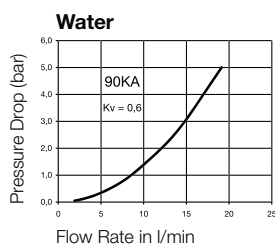
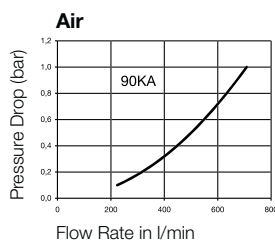

Material

Coupling

Back Body
Valve Body
Sleeve
Valve
Spring and Locking Ring
Locking Pins
Seals

Standard

Brass
Brass
Brass
Brass
AISI 301
AISI 420
NBR

Nickel Plated

Brass, Nickel Plated
Brass, Nickel Plated
Brass, Nickel Plated
Brass
AISI 301
AISI 420
NBR

Plug (21 Series)

Plug

Brass

Brass, Nickel Plated

Couplings

RECTUS Series 90KA

	Connection A	Hex SW	L mm	D mm	L1 mm	L2 mm	Hex1 SW1	B mm	G mm	Version	Part Number
<p>Male Thread</p>	G 1/8	14	36	20	7					Standard	90KA AW10 MPX
										Nickel Plated	90KA AW10 MPN
	G 1/4	17	38	20	9					Standard	90KA AW13 MPX
										Nickel Plated	90KA AW13 MPN
<p>Female Thread</p>	G 3/8	19	39	20	9					Standard	90KA AW17 MPX
										Nickel Plated	90KA AW17 MPN
	G 1/4	17	38	20	9					Standard	90KA IW13 MPX
										Nickel Plated	90KA IW13 MPN
	G 3/8	19	38	20	9					Standard	90KA IW17 MPX
										Nickel Plated	90KA IW17 MPN

Couplings

RECTUS Series 90KA

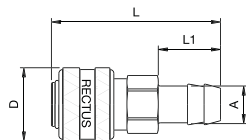

Hose Barb

Connection A	Hex SW	L mm	D mm	L1 mm	L2 mm	Hex1 SW1	B mm	G mm	Version	Part Number
6 mm	14	46	20	17					Standard	90KA TF06 MPX
									Nickel Plated	90KA TF06 MPN
8 mm	14	46	20	17					Standard	90KA TF08 MPX
									Nickel Plated	90KA TF08 MPN
9 mm	14	46	20	17					Standard	90KA TF09 MPX
									Nickel Plated	90KA TF09 MPN
10 mm	14	46	20	17					Standard	90KA TF10 MPX
									Nickel Plated	90KA TF10 MPN

Plugs

RECTUS Series 21SF

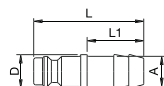

Hose Barb

Connection A	Hex SW	L mm	D mm	L1 mm	L2 mm	Hex1 SW1	B mm	G mm	Version	Part Number
4 mm		32	9	17					Standard	21SF TF04 MXX
									Nickel Plated	21SF TF04 MXN
5 mm		32	9	17					Standard	21SF TF05 MXX
									Nickel Plated	21SF TF05 MXN
6 mm		32	9	17					Standard	21SF TF06 MXX
									Nickel Plated	21SF TF06 MXN
8 mm		32	9	17					Standard	21SF TF08 MXX
									Nickel Plated	21SF TF08 MXN
9 mm		33	10	17					Standard	21SF TF09 MXX
									Nickel Plated	21SF TF09 MXN
10 mm		33	12	17					Standard	21SF TF10 MXX
									Nickel Plated	21SF TF10 MXN

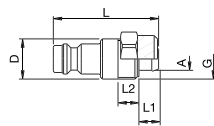

Plastic Hose Connection

4 x 6 mm		32	10	6	6			M 10 x 1	Standard	21SF KO06 MXX
									Nickel Plated	21SF KO06 MXN
6 x 8 mm		32	12	6	6			M 12 x 1	Standard	21SF KO08 MXX
									Nickel Plated	21SF KO08 MXN
8 x 10 mm	17	36		9	8			M 16 x 1	Standard	21SF KO10 MXX
									Nickel Plated	21SF KO10 MXN
8 x 12 mm	17	36		9	8			M 16 x 1	Standard	21SF KO12 MXXS
									Nickel Plated	21SF KO12 MXNS

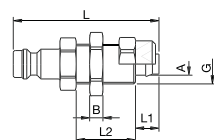

Panel Mount,
Plastic Hose Connection

4 x 6 mm	14	43		7	18	12	3	M 10 x 1	Standard	21SF KS06 MXX
									Nickel Plated	21SF KS06 MXN
4 x 6 mm	14	44		7	18	17	4	M 12 x 1	Standard	21SF KS08 MXX
									Nickel Plated	21SF KS08 MXN

⚠ Please consider our security advices on the pages 12/13 ⚠

Plugs

RECTUS Series 21SF

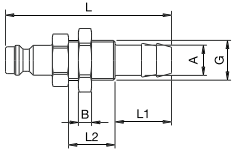
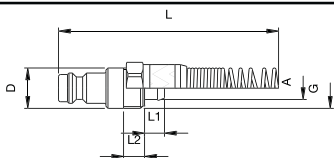
	Connection A	Hex SW	L mm	D mm	L1 mm	L2 mm	Hex1 SW	B mm	G mm	Version	Part Number
 <p>Panel Mount Hose Barb</p>	4 mm	14	50		17	14	14	4	M 10 x 1	Standard	21SF TS04 MXX
										Nickel Plated	21SF TS04 MXN
	5 mm	14	50		17	14	17	4	M 12 x 1	Standard	21SF TS05 MXX
										Nickel Plated	21SF TS05 MXN
	6 mm	14	50		17	14	17	4	M 12 x 1	Standard	21SF TS06 MXX
										Nickel Plated	21SF TS06 MXN
	8 mm	14	50		17	14	17	4	M 12 x 1	Standard	21SF TS08 MXX
										Nickel Plated	21SF TS08 MXN
	9 mm	14	50		17	14	17	4	M 12 x 1	Standard	21SF TS09 MXX
										Nickel Plated	21SF TS09 MXN
	10 mm	17	50		17	14	19	4	M 14 x 1	Standard	21SF TS10 MXX
										Nickel Plated	21SF TS10 MXN
 <p>Plastic Hose Connection with Spring Guard</p>	4 x 6 mm		115		6	6			M 10 x 1	Standard	21SF KK06 MXX
										Nickel Plated	21SF KK06 MXN
	6 x 8 mm		120		6	6			M 12 x 1	Standard	21SF KK08 MXX
										Nickel Plated	21SF KK08 MXN

Plugs

RECTUS Series 21SF

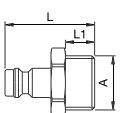
	Connection A	Hex SW	L mm	D mm	L1 mm	L2 mm	Hex1 SW	B mm	G mm	Version	Part Number	
 <p>Male Thread</p>	G 1/8	14	25		7					Standard	21SF AW10 MXX	
										Nickel Plated	21SF AW10 MXN	
	G 1/4	17	28		9					Standard	21SF AW13 MXX	
										Nickel Plated	21SF AW13 MXN	
	G 3/8	19	28		9					Standard	21SF AW17 MXX	
										Nickel Plated	21SF AW17 MXN	
	ISO 8434-1	M 10 x 1	14	26		8					Standard	21SF AD10 MXX
											Nickel Plated	21SF AD10 MXN
	ISO 8434-1	M 12 x 1,5	17	28		10					Standard	21SF AD12 MXX
											Nickel Plated	21SF AD12 MXN
	ISO 8434-1	M 14 x 1,5	19	28		10					Standard	21SF AD14 MXX
											Nickel Plated	21SF AD14 MXN

Plugs

RECTUS Series 21SF

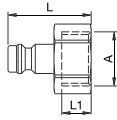

Female Thread

Connection A	Hex SW	L mm	D mm	L1 mm	L2 mm	Hex1 SW1	B mm	G mm	Version	Part Number
G 1/8	14	25	8						Standard	21SF IW10 MXX
									Nickel Plated	21SF IW10 MXN
G 1/4	17	25	9						Standard	21SF IW13 MXX
									Nickel Plated	21SF IW13 MXN
G 3/8	19	26	9						Standard	21SF IW17 MXX
									Nickel Plated	21SF IW17MXN
M 10 x 1	14	26	9						Standard	21SF IM10 MXX
									Nickel Plated	21SF IM10 MXN
M 12 x 1,5	17	27	10						Standard	21SF IM12 MXX
									Nickel Plated	21SF IM12 MXN
M 14 x 1,5	17	27	10						Standard	21SF IM14 MXX
									Nickel Plated	21SF IM14 MXN

Brass/Steel

Low Pressure

⚠ Please consider our security advices on the pages 12/13 ⚠